

REFER ADJACENT LAYOUT FOR CONTINUATION

INSET

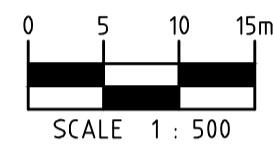

SCALE 1 : 500

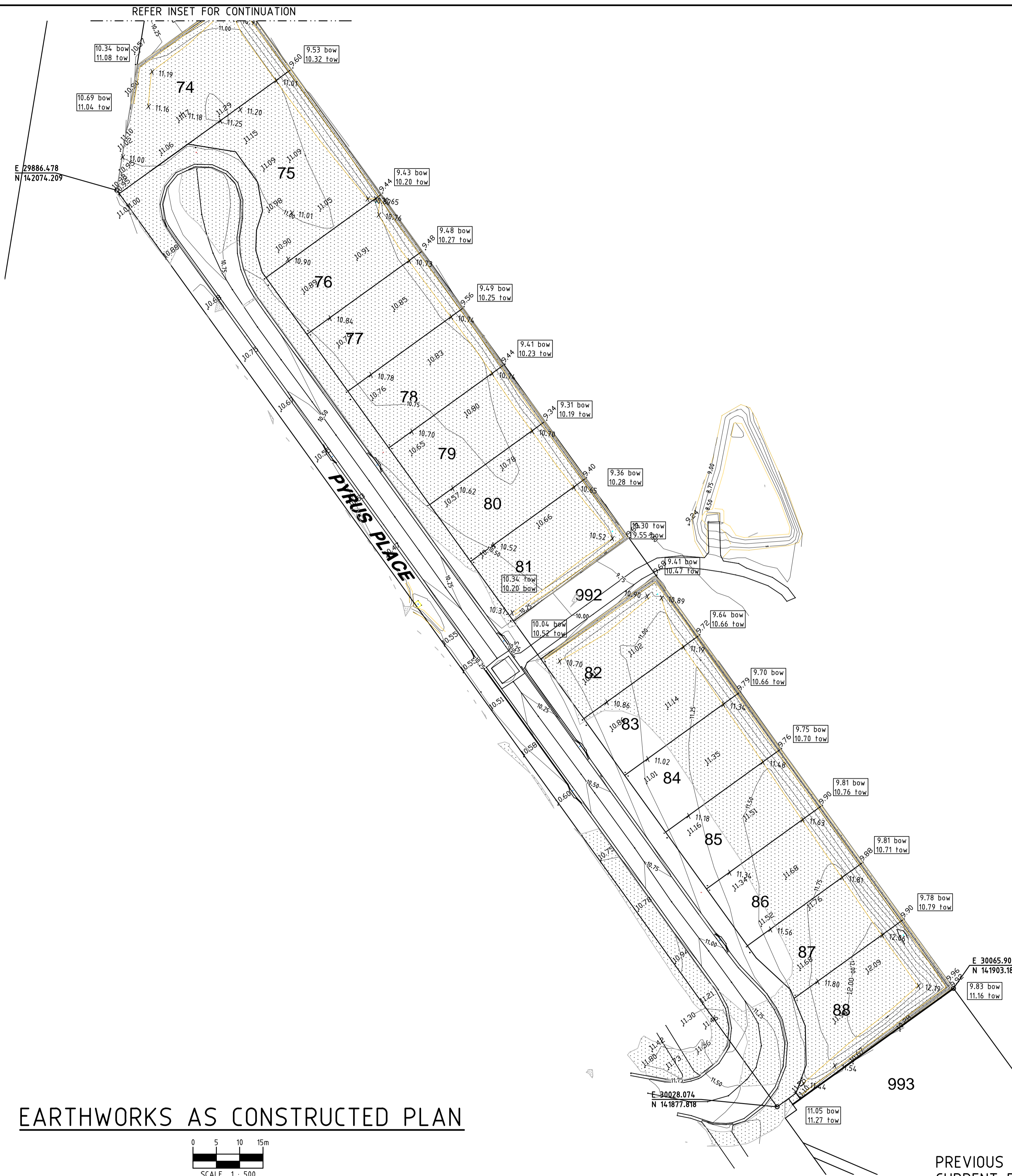

EARTHWORKS AS CONSTRUCTED PLAN

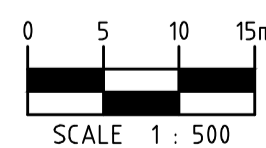

SCALE 1 : 500

LEGEND

- EXTENT OF FILL
- SURFACE SPOT LEVELS
- CONTOUR MAJOR
- CONTOUR MINOR

WORKS AS CONSTRUCTED

IT IS CERTIFIED THAT THE LOCATION, LEVELS AND DIMENSIONS OF THE INFRASTRUCTURE SHOWN HEREIN ARE A TRUE REPRESENTATION OF THE CONSTRUCTED WORKS AND THAT THE AS-CONSTRUCTED SURVEY WAS PERFORMED TO THE PRESCRIBED ACCURACY STANDARDS.

Signature (Director) Date 16/3/2016

Signature (Director)

COTTRELL CAMERON & STEEN SURVEYS Pty. Ltd.

WORKS AS CONSTRUCTED

IT IS CERTIFIED THAT WORKS HEREIN HAVE BEEN CONSTRUCTED TO LOCAL GOVERNMENT STANDARDS, RELEVANT APPROVED SPECIFICATIONS AND THE OPERATIONAL WORKS APPROVAL. THE AS-CONSTRUCTED DRAWINGS FOR THESE WORKS CONSTITUTES A TRUE AND CORRECT RECORD OF THE WORKS CONSTRUCTED AND COMPLIES WITH THE DESIGN INTENT.

Signature RPEQ No. 15957

CRAIG HURLEY

Date of Practical Completion 19-10-2015

FOR AND ON BEHALF OF

LAMBERT & REHBEIN (SEQ) PTY. LTD.

LAMBERT & REHBEIN
ENGINEERS • MANAGERS • SCIENTISTS

CBD HOUSE
LEVEL 3, 120 WICKHAM STREET
FORTITUDE VALLEY QLD 4006
P.O. BOX 112 FORTITUDE VALLEY QLD 4006
A.C.N. 010 451 902

TELEPHONE (07) 3250 9000
FACSIMILE (07) 3250 9001
EMAIL mail@lar.net.au



Project: **PROPOSED RESIDENTIAL SUBDIVISION**
58-98 DONALD ROAD
REDLAND BAY - STAGE 5

Title: **EARTHWORKS AS CONSTRUCTED PLAN**

Client: **Harridan Pty Ltd**

Draftsperson:

Checked:

Designer:

Approved: A. PEZZUTTI
RPEQ No. 6382

Scale: **AS SHOWN**

Date: **DEC 2015**

Sheet Size: **A1**
Drawing No.: **B02553-C553**

Client Ref: OPW001621
PREVIOUS RCC App. Ref. EC005056.5
CURRENT RCC App. Ref. ROL005647

Associated Consultants:		R.P.D.			
COTTRELL CAMERON & STEEN SURVEYS Pty Ltd		Lot 2			
107 MILES PLATING ROAD		R.P. 98600			
EIGHT MILES PLAINS		Parish of REDLAND			
Qld 4113		County of STANLEY			
Phone: (07) 334 09700	Fax: (07) 3862 6210	LEVEL DATUM			
		A.H.D. DERIVED			
		P.S.M. 97804			
		R.L. 11.656			
No.	Date	By	Amendment	Checked	
B	15-03-16	R.T.	REVISED AS CONSTRUCTION ISSUE		
A	12-01-16	R.T.	AS CONSTRUCTED ISSUE		

THIS DESIGN AND DRAWING IS COPYRIGHT. NO PART OF THIS DRAWING MAY BE REPRODUCED, STORED IN A RETRIEVAL SYSTEM OR TRANSMITTED IN ANY FORM WITHOUT THE WRITTEN PERMISSION OF LAMBERT AND REHBEIN PTY LTD